

UNO-3382G

UNO-3384G

Intel® Core™ i7/Celeron® Control Cabinet PC w/ 2 x GbE, 2 x mPCIe, HDMI/DP

NEW



Features

- 4th Generation Intel® Core™ i7/Celeron® Processors with 8GB/4GB DDR3L Memory
- 2 x GbE, 2 x USB 2.0, 2 x USB 3.0, 1 x RS-232/RS-422/485, 1 x HDMI, 1 x DP, 2 x PCI/PCIe, 2 x mPCIe (2 x full)
- Hot-Swappable HDD/SSD support for RAID 0/1
- Protection Technology of optional UPS is compatible with UNO-3300 series which enhances the quality of input power and secure the data safety
- Supports Fieldbus Protocol by iDoor Technology 3G/GPS/GPRS/Wi-Fi Communication by iDoor Technology
- Supports MRAM by iDoor Technology
- LAN Redundancy (Teaming)

Introduction

Advantech's UNO-3300 series offer an open and universal automation solution. The newest UNO-3300 series of the Control Cabinet PC have attractive and flexible extension capabilities such as 2 x USB 2.0 ports and 2 x USB 3.0 ports, 1 x HDMI, 1 x DP, 1 x COM ports, 2 x LANS, 2 x mPCIe and 2 x PCI/PCIe. It's a reliable industrial control machine certified by industrial automation standard IEC-61010.

Specifications

General

- Certification** CE, FCC, UL
- Dimensions (W x D x H)** UNO-3382G: 65.2 x 254 x 207 mm (2.5" x 10" x 8.15")
UNO-3384G: 103.2 x 254 x 207 mm (4.06" x 10" x 8.15")
Regular Size
- Form Factor** Aluminum Housing
- Enclosure** Book mounting
- Mounting** UNO-3382G: 3.1kg
UNO-3384G: 3.9kg
- Weight (Net)** 24 V_{DC} ± 20%
- Power Requirements** 45 W (Typical)
- Power Consumption** WIN7/8, WES7, WES10, Advantech Linux
- OS Support**

System Hardware

- BIOS** AMI UEFI 128Mbit Flash BIOS
- Watchdog Timer** Programmable 256 levels timer interval, from 1 to 255 sec
- Processor** Intel® Core™ i7-4650U 1.7GHz Haswell, 4MB L2
Intel® Celeron® 2980U 1.6GHz, 2MB L2
- System Chip** Integrated Intel 8 Series Chipset
- Memory** Built-in 4GB/8GB DDR3L 1333 MHz
- Graphics Engine** Intel® HD graphics 5000
- Ethernet** Intel® i210-ITGbE
- LED Indicators** LEDs for Power, Battery, Tx/Rx, HDD and reserved x 2
- Storage** 1 x CFAST slot
Two built-in 2.5" SATA HDD brackets with support for RAID 0/1. (Compatible with 9.5mm height HDD)
UNO-3382G: 2 Full-size mPCIe
UNO-3384G: 2 Full-size mPCIe, 1x PCIe x4, 1x PCI
(total combined power consumption on the PCI/PCIe slots should be less than 20W)
- Expansion**

I/O Interfaces

- Serial Ports** 1 x RS-232/422/485, DB9, auto flow control, 50-115.2kbps
- LAN Ports** 2 x RJ45, 10/100/1000 Mbps IEEE 802.3u 1000Base-T Fast Ethernet
- USB Ports** 4 x USB Ports (2 x USB 2.0, 2 x USB 3.0 compliant)
- Displays** 1 x HDMI, supports 1920 x 1200 @ 60Hz 24bpp
1 x DP, supports 3200 x 2000 @ 60Hz 24bpp
- Power Connector** 1 x 3 Pin, Terminal Block

Environment

- Operating Temperature** 0 ~ 55°C (32 ~ 131°F) @ 5 ~ 85% RH with 0.7m/s airflow (Industry SSD)
- Storage Temperature** -40 ~ 85°C (-40 ~ 185°F)
- Relative Humidity** 10 ~ 95% RH @ 40°C, non-condensing
- Shock Protection** Operating, IEC 60068-2-27, 20G, half sine, 11ms
- Vibration Protection** Operating, IEC 60068-2-64, 2Grms, random, 5 ~ 500Hz, 1hr/axis (mSATA)

Installation Scenario

Book mounting

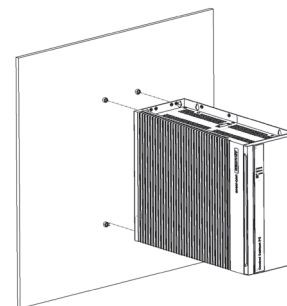

Wall mount

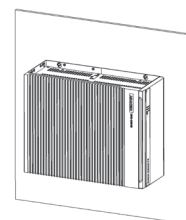

Dimensions

Unit: mm

UNO-3382G

UNO-3384G

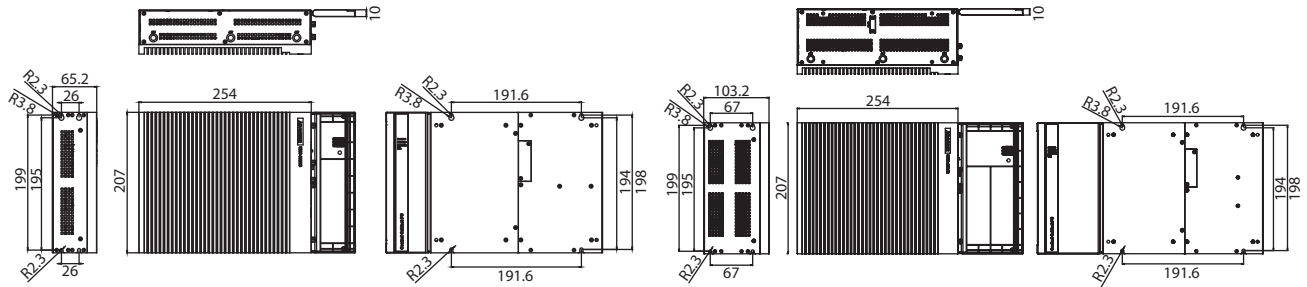

I/O View

UNO-3384G

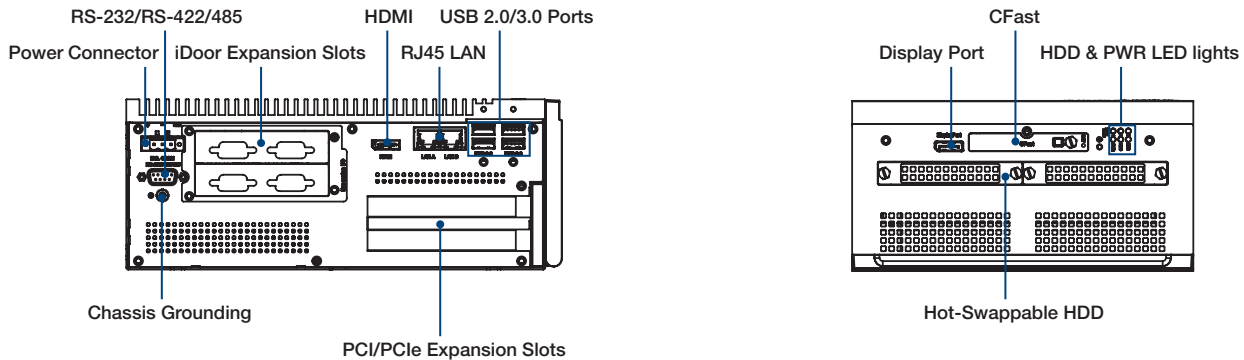

Ordering Information

- **UNO-3382G-474AE** Intel® Core™ i7-4650U 1.7GHz, 8GB, 2 x LANs, 2 x Full-size mPCIe, 1 x HDMI, 1 x DP
- **UNO-3384G-474AE** Intel® Core™ i7-4650U 1.7GHz, 8GB, 2 x LANs, 1 x PCIe4, 1 x PCI, 2 x Full-size mPCIe, 1 x HDMI, 1 x DP
- **UNO-3382G-4C3AE** Intel® Celeron® 2980U 1.6GHz, 4GB, 2 x LANs, 2 x Full-size mPCIe, 1 x HDMI, 1 x DP
- **UNO-3384G-4C3AE** Intel® Celeron® 2980U 1.6GHz, 4GB, 2 x LANs, 1 x PCIe4, 1 x PCI, 2 x Full-size mPCIe, 1 x HDMI, 1 x DP

Optional Accessories

- **UNO-IPS2730-AE** UPS module
- **UNO-3300FAN-AE** FAN kit for UNO-3384G series
- **96PSA-A150W24T2** 150W AC to DC power adapter
- **1702002600** Power Cable US Plug 1.8 M
- **1702002605** Power Cable EU Plug 1.8 M
- **1702031801** Power Cable UK Plug 1.8 M
- **1700000596** Power Cable China/Australia Plug 1.8 M

Embedded O/S

- **2070013477** Image WES7P X64 MUI. for UNO-3382G/3384G
- **2070013478** Image Linux for UNO-3382G/3384G

iDoor Modules

- **PCM-24R2PE-AE** 2-Port Gigabit Ethernet, IEEE 802.3af (PoE) Compliant, mPCIe, RJ45
- **PCM-24R2GL-AE** 2-Port Gigabit Ethernet, mPCIe, RJ45
- **PCM-24D2R4-AE** 2-Port Isolated RS-422/485 mPCIe, DB9
- **PCM-24D4R4-AE** 4-Port Non-Isolated RS-422/485 mPCIe, DB37
- **PCM-27D24DI-AE** 24-Channel Isolated Digital I/O w/ counter mPCIe, DB37
- **PCM-24S2WF-AE** Wi-Fi 802.11 a/b/g/n 2T2R w/ Bluetooth4.0, Half-size mPCIe, 2-port SMA
- **PCM-26R2PN-MAE** 2-Port Hilscher netX100 FieldBus mPCIe, PROFINET, RJ45, Master
- **PCM-26R2PN-SAE** 2-Port Hilscher netX100 FieldBus mPCIe, PROFINET, RJ45, Slave
- **PCM-26R2EC-MAE** 2-Port Hilscher netX100 FieldBus mPCIe, EtherCAT, RJ45, Master
- **PCM-26R2EC-SAE** 2-Port Hilscher netX100 FieldBus mPCIe, EtherCAT, RJ45, Slave
- **PCM-26R2EI-MAE** 2-Port Hilscher netX100 FieldBus mPCIe, Ethernet/IP, RJ45, Master
- **PCM-26R2EI-SAE** 2-Port Hilscher netX100 FieldBus mPCIe, Ethernet/IP, RJ45, Slave
- **PCM-26D1DB-MAE** 1-Port Hilscher netX100 FieldBus mPCIe, PROFIBUS, DB9, Master
- **PCM-26D1DB-SAE** 1-Port Hilscher netX100 FieldBus mPCIe, PROFIBUS, DB9, Slave